

# euroKing cylinder Mountings

VDMA24562  
ISO6431  
CNOMO

## Cylinder Mountings

The mountings available for the euroKing cylinder range conform to the ISO6431 and VDMA standards. They enable the cylinders to be directly interchangeable with those of other leading manufacturers.

Mountings are supplied complete with the appropriate fixing screws, hinge pins, clips and washers to attach them to the cylinder bodies.

Piston rod attachments are either zinc-plated or corrosion resistant natural finish.

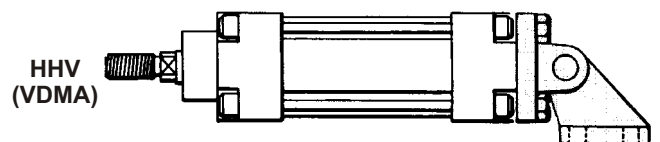
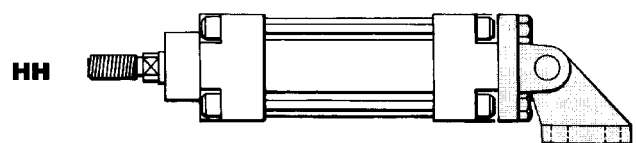
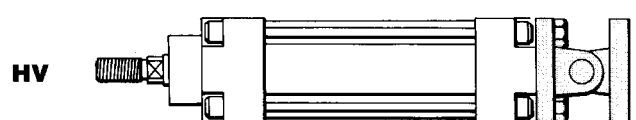
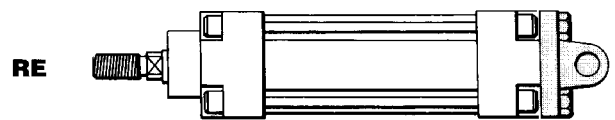
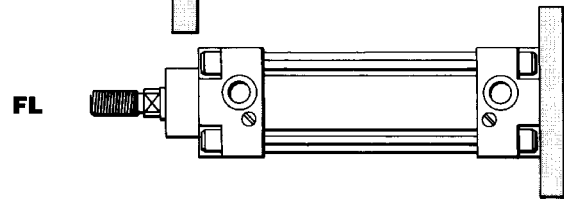
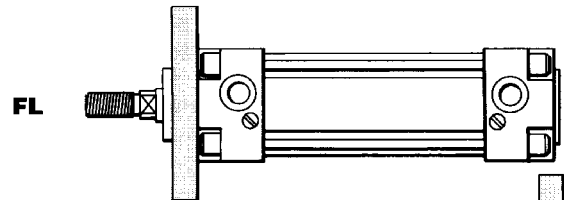
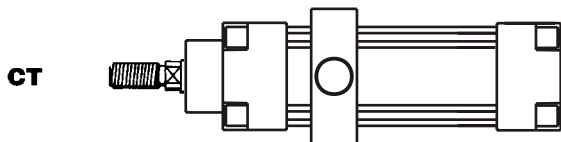
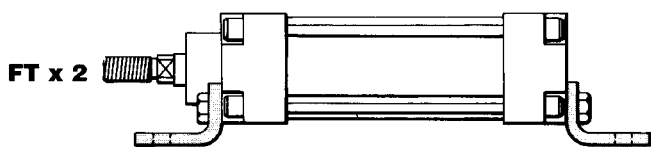
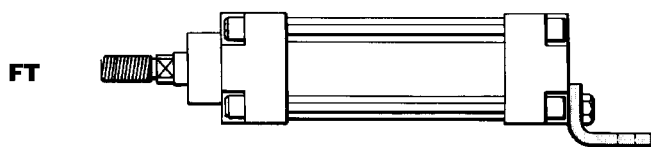
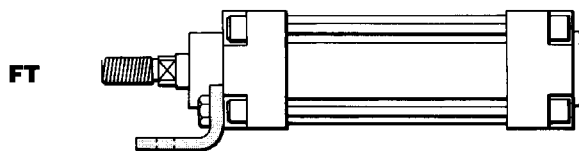
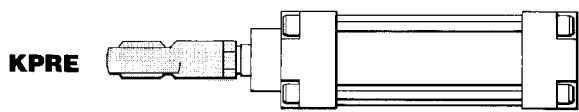
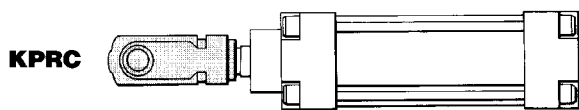

## Dimensions

units mm

### Body mountings for euroKing ISO 6431 cylinders

#### Single Pedestal Mounting KCIM...FT

Part Number	Ø mm	H13 Js15					N	P	Js14			±1.25	
		AB	AH	AO	AT	AU			R	TR	XA	AW	
KCIM 32 FT	32	7	32	11	5	24	15.75	26	15.5	32	144	2	
KCIM 40 FT	40	9	36	9	5	28	17.00	27	18.0	36	163	2	
KCIM 50 FT	50	9	45	11	6	32	21.75	35	20.5	45	175	5	
KCIM 63 FT	63	9	50	13	6	32	21.75	35	23.0	50	190	5	
KCIM 80 FT	80	12	63	14	7	41	27.00	46	23.0	63	215	5	
KCIM 100 FT	100	14	71	14	7	41	26.50	48	28.0	75	230	10	

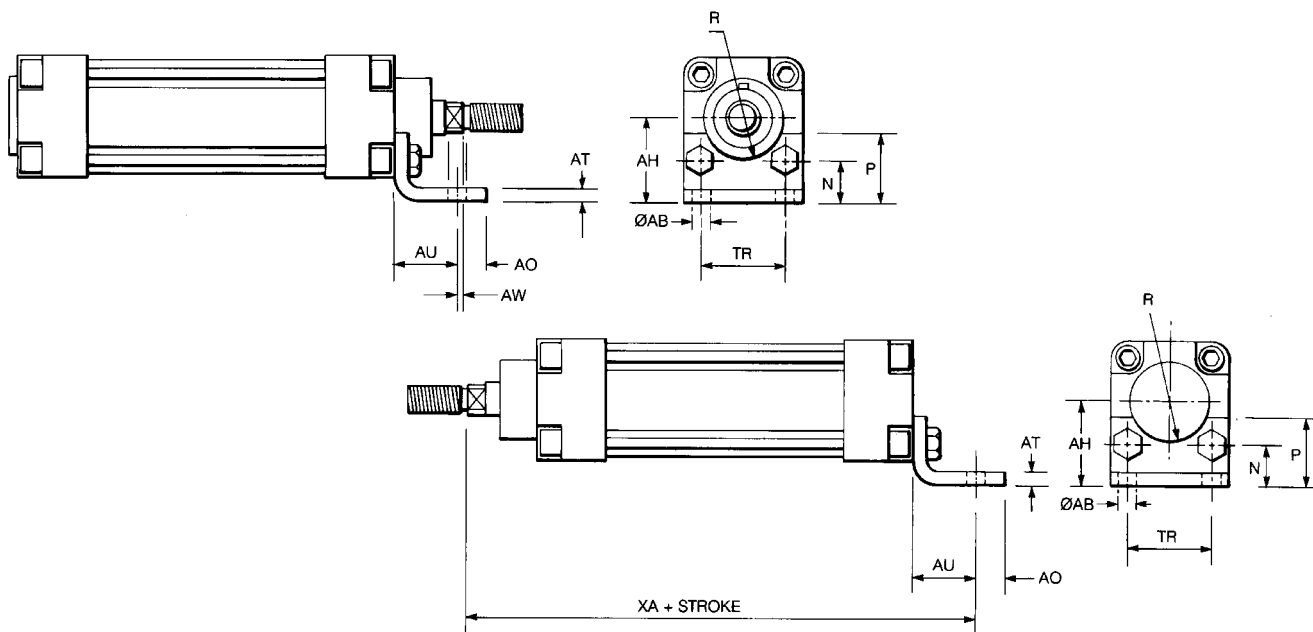

#### Double Pedestal Mounting KCIM...FT x 2

Part Number	Ø mm	H13 Js15					N	P	R	Js14		±1.25
		AB	AH	AO	AT	AU				SA	TR	XA
KCIM 32 FT x 2	32	7	32	11	5	24	15.75	26	15.5	142	32	144
KCIM 40 FT x 2	40	9	36	9	5	28	17.00	27	18.0	161	36	163
KCIM 50 FT x 2	50	9	45	11	6	32	21.75	35	20.5	170	45	175
KCIM 63 FT x 2	63	9	50	13	6	32	21.75	35	23.0	185	50	190
KCIM 80 FT x 2	80	12	63	14	7	41	27.00	46	23.0	210	63	215
KCIM 100 FT x 2	100	14	71	14	7	41	26.50	48	28.0	220	75	230

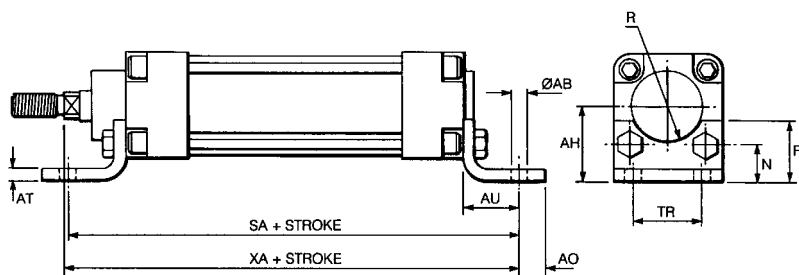

Ordering Information:  
By part number



## Dimensions

units mm

### Intermediate Trunnion

#### KCIM...CT

Available to special order

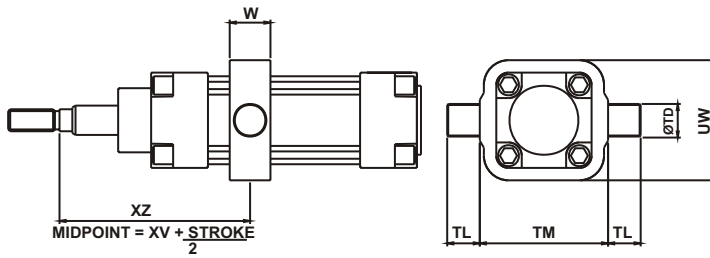

Part Number	$\varnothing$ mm	max R	e9 TD	h14 TL	h14 TM	UW	W	$\pm 1$ no m XV	$\pm 1$ min *XZ
KCIM 32 CT	32	1.0	12	12	50	49.0	17.5	73.0	79.0
KCIM 40 CT	40	1.5	16	16	63	60.0	20.5	82.5	87.0
KCIM 50 CT	50	1.6	16	16	75	71.0	20.5	90.0	102.0
KCIM 63 CT	63	1.6	20	20	90	85.0	26.0	97.5	102.0
KCIM 80 CT	80	1.6	20	20	110	106.0	26.0	110.0	122.5
KCIM 100 CT	100	2.0	25	25	132	129.0	32.0	120.0	122.5

\* XZ to be specified by customer

This dimension must be greater than the minimum dimension given in the table above.

### Rear Eye

#### KCIM...RE

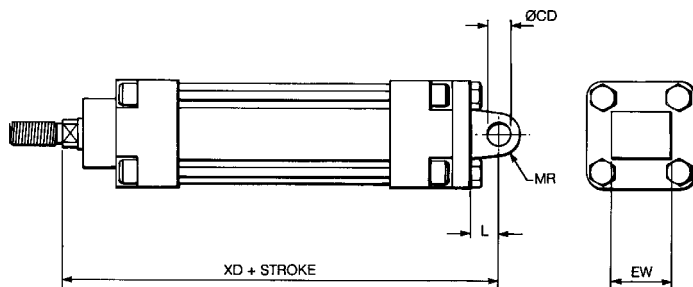

Part Number	$\varnothing$ mm	H9 CD	L	MR	$-0.2$ $-0.6$ EW	$\pm 1.25$ XD
KCIM 32 RE	32	10	12	9	26	142
KCIM 40 RE	40	12	15	12	28	160
KCIM 50 RE	50	12	15	13	32	170
KCIM 63 RE	63	16	20	17	40	190
KCIM 80 RE	80	16	20	17	50	210
KCIM 100 RE	100	20	25	21	60	230

Ordering Information:  
By part number



## Dimensions

units mm

### Flange Mounting KCIM...FL

Part Number	Ø mm	F	H13 FB	Js14 R	UF	± 1.6 W	ZB	Js14 TF	E	2F ±1.25 ZF
KCIM 32 FL	32	10	7	32	80	16	120	64	50	130
KCIM 40 FL	40	10	9	36	90	20	135	72	55	145
KCIM 50 FL	50	12	9	45	110	25	143	90	65	155
KCIM 63 FL	63	12	9	50	120	25	158	100	75	170
KCIM 80 FL	80	16	12	63	153	30	174	126	95	190
KCIM 100 FL	100	16	14	75	178	35	189	150	115	205

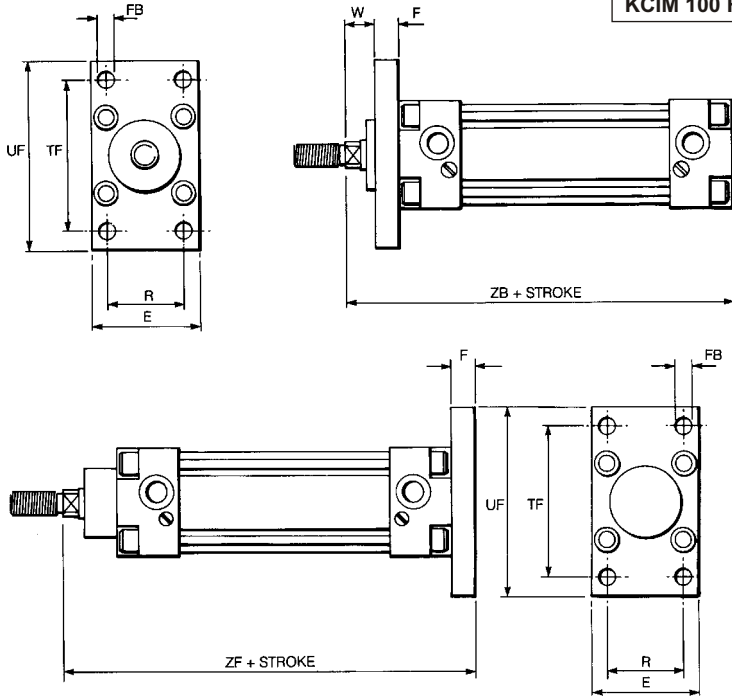

### Clevis and Pin KCIM...C

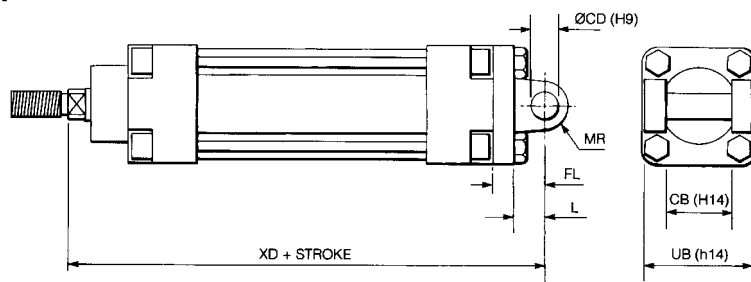

Part Number	Ø mm	H14 CB	H9 CD	L	MR	h14 UB	±1.25 XD	FL
KCIM 32 C	32	26	10	12	9	45	142	22
KCIM 40 C	40	28	12	15	12	52	160	25
KCIM 50 C	50	32	12	15	13	60	170	27
KCIM 63 C	63	40	16	20	17	70	190	32
KCIM 80 C	80	50	16	20	17	90	210	36
KCIM 100 C	100	60	20	25	21	110	230	41

Ordering Information:  
By part number



## Dimensions

units mm

### Horizontal Rear Hinge KCIM...HH

Part Number	Ø mm	EK	G1	G2	G3	H6	K1	K2	KL	NH	S5	XD
KCIM 32 HH	32	10	32.5	32.6	45	10	32.5	45	55	32	7	142
KCIM 40 HH	40	12	38.0	38.0	52	10	38.0	52	63	36	7	160
KCIM 50 HH	50	12	46.5	46.5	65	12	46.5	65	71	45	9	170
KCIM 63 HH	63	16	56.5	56.5	75	12	56.5	75	83	50	9	190
KCIM 80 HH	80	16	72.0	72.0	95	16	72.0	95	103	63	11	210
KCIM 100 HH	100	20	89.0	89.0	115	16	89.0	115	123	73	11	230

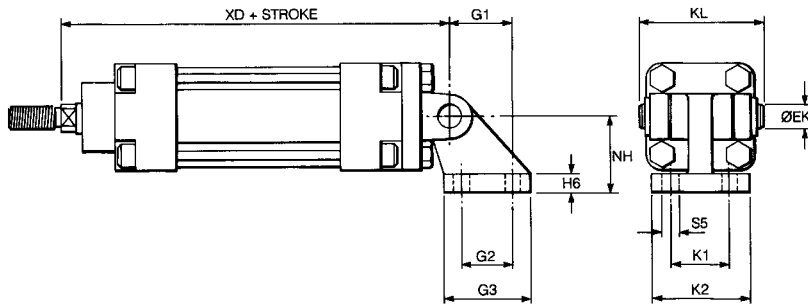

### Vertical Rear Hinge KCIM...HV

Part Number	Ø mm	CD	E	EK	FL	KL	HH	HT	TG	XD
KCIM 32 HV	32	10	45	10	22	55	7	10	32.5	142
KCIM 40 HV	40	12	52	12	25	63	7	10	38.0	160
KCIM 50 HV	50	12	65	12	27	71	9	12	46.5	170
KCIM 63 HV	63	16	75	16	32	83	9	12	56.5	190
KCIM 80 HV	80	16	95	16	36	103	11	16	72.0	210
KCIM 100 HV	100	20	115	20	41	123	11	16	89.0	230

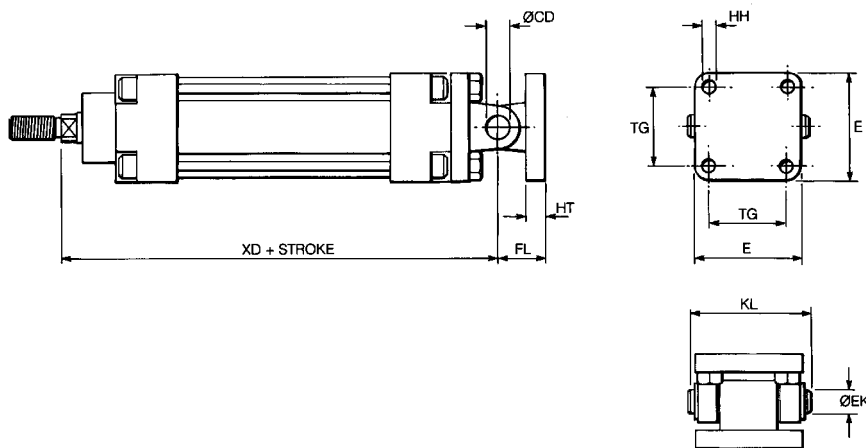

Ordering Information:  
By part number



## Dimensions

units mm

### Piston Rod Mountings for euroKing ISO 6431 cylinders

#### Piston Rod Eye

##### KPRE

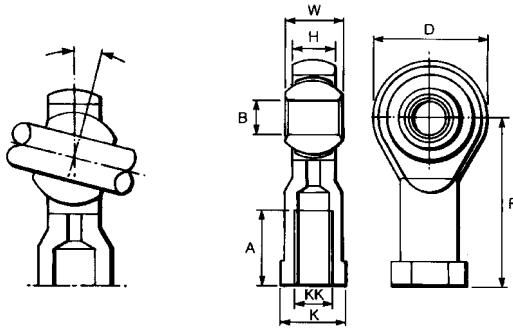

Part Number	Ø mm	KK	A min	B <sup>H7</sup>	W	H	F	D	K
KPRE 10	32	M10 x 1.25	20	10	<sup>+0</sup> <sub>-0.1</sub> 14	10.5	43	28	17
KPRE 12	40	M12 x 1.25	22	12	16	12.0	50	32	19
KPRE 16	50-63	M16 x 1.5	28	16	21	15.0	64	42	22
KPRE 20	80-100	M20 x 1.5	33	20	25	18.0	77	50	30

#### Materials:

- Housing - Carbon steel 30 - 40T
- Ball - 1% CR steel
- Bush - Bronze

#### Piston Rod Clevis

##### KPRC

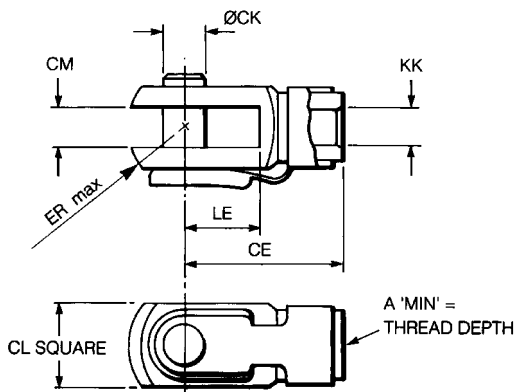

Part Number	Ø mm	KK	A min	Ø CK	CE	CL max	CM	LE	ER max
KPRC 10	32	M10 x 1.25	20	10	40	20	10 <sup>+0.5</sup> <sub>+0.15</sub>	20	12
KPRC 12	40	M12 x 1.25	22	12	48	24	12 <sup>+0.5</sup> <sub>+0.15</sub>	24	16
KPRC 16	50-63	M16 x 1.5	28	16	64	32	16 <sup>+0.5</sup> <sub>+0.15</sub>	32	19
KPRC 20	80-100	M20 x 1.5	33	20	80	40	20 <sup>+0.6</sup> <sub>+0.15</sub>	40	25

Ordering Information:  
By part number

