

RACCORDI STANDARD IN OTTONE - SERIE 1000

standard fittings in brass

DATI TECNICI

- ▼ Applicazioni
- Materiale utilizzato
- Finitura superficiale dell'ottone
- Filettature

Pneumatica ed Idraulica
Ottone UNI EN 12164 CW614 N
Nichelatura
Gas Conica - ISO 7 - DIN 2999 - BS 21
Gas Cilindrica - ISO 228
Metrica - ISO R/262



Technical specifications

- ▼ *applications*
- *materials used*
- *surface coating*
- *threads*

*pneumatic and hydraulic systems
brass UNI EN 12164 CW614 N
nickel plating
taper gas - ISO 7 - DIN 2999 - BS 21
cylindrical gas - ISO 228
metric - ISO R/262*

RACCORDI STANDARD IN OTTONE - SERIE 1000

standard fittings in brass

1105

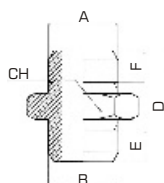

CODE	A	B	D	E	F	CH	
1105TRM5	M5	M5	11.5	2.5	2.5	8	100
1105TR18	1/8"	1/8"	16.5	6	6	14	100
1105TR14	1/4"	1/4"	21	6	6	17	100
1105TR38	3/8"	3/8"	23	6.5	6.5	19	100
1105TR12	1/2"	1/2"	25.5	6.5	6.5	24	50
1105TR34	3/4"	3/4"	28.8			30	50
1105TR1	1"	1"	33.8			36	25

nipplo cilindrico - *parallel nipple*

1107

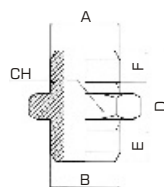

CODE	A	B	D	E	F	CH	
1107TRM518	M5	1/8"	14.5	4.5	2.5	14	100
1107TR1814	1/8"	1/4"	19	6	4.5	17	100
1107TR1838	1/8"	3/8"	20	6.5	4.5	19	100
1107TR1438	1/4"	3/8"	22	6.5	6	19	100
1107TR1412	1/4"	1/2"	23.5	6.5	6	24	100
1107TR3812	3/8"	1/2"	24.5	6.5	6.5	24	50
1107TR3834	3/8"	3/4"	29			30	50
1107TR1234	1/2"	3/4"	29			30	50
1107TR341	3/4"	1"	31.9			36	25

nipplo cilindrico ridotto - *reduced parallel nipple*

1110

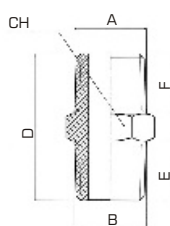

CODE	A	B	D	E	F	CH	
1110TR18	1/8"	1/8"	20	8	8	12	100
1110TR14	1/4"	1/4"	27	11	11	14	100
1110TR38	3/8"	3/8"	28	11.5	11.5	17	100
1110TR12	1/2"	1/2"	33.5	14	14	22	50
1110TR34	3/4"	3/4"	40	16.5	16.5	27	50
1110TR1	1"	1"	32.7			34	25

nipplo conico - *taper nipple*

1112

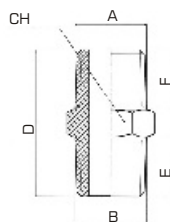

CODE	A	B	D	E	F	CH	
1112TR1814	1/8"	1/4"	24	11	8	14	100
1112TR1838	1/8"	3/8"	24.5	11.5	8	17	100
1112TR1438	1/4"	3/8"	27.5	11.5	11	17	100
1112TR1412	1/4"	1/2"	30.5	14	11	22	100
1112TR3812	3/8"	1/2"	31	14	11.5	22	50
1112TR1234	1/2"	3/4"	37.5	16.5	14	27	50
1112TR341	3/4"	1"	38.3			36	25

nipplo conico ridotto - *reduced taper nipple*

1 1 1 5

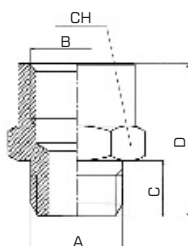

CODE	A	B	C	D	CH	
1115TRM5	M5	M5		11	8	100
1115TRM518	M5	1/8"	4	15.5	14	100
1115TRM618	M6	1/8"		17.3	14	100
1115TR18	1/8"	1/8"	6	16.5	14	100
1115TR1814	1/8"	1/4"	6	20.5	17	100
1115TR1838	1/8"	3/8"	6	23	22	100
1115TR14	1/4"	1/4"	8	22	17	100
1115TR1438	1/4"	3/8"	8	24	22	100
1115TR1412	1/4"	1/2"	8	28.5	26	100
1115TR38	3/8"	3/8"	9	25	22	100
1115TR3812	3/8"	1/2"	9	29.5	24	50
1115TR3834	3/8"	3/4"		26.7	32	50
1115TR12	1/2"	1/2"	10	30.5	24	50
1115TR1234	1/2"	3/4"		28.4	32	50
1115TR34	3/4"	3/4"		28	32	50
1115TR121	1/2"	1"		29	38	25
1115TR341	3/4"	1"		29	38	25
1115TR1	1"	1"		31	38	25

prolunga M/F cilindrica - *M/F parallel extension*

1 1 2 0

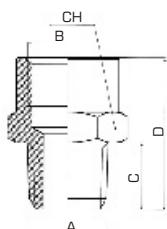

CODE	A	B	C	D	CH	
1120TR18	1/8"	1/8"	8	16	14	100
1120TR1814	1/8"	1/4"	8	16.5	17	100
1120TR1838	1/8"	3/8"	8	19.5	22	100
1120TR14	1/4"	1/4"	11	16.5	17	100
1120TR1438	1/4"	3/8"	11	19.5	22	100
1120TR1412	1/4"	1/2"	11	19.5	22	100
1120TR38	3/8"	3/8"	11.5	23.5	27	100
1120TR3812	3/8"	1/2"	11.5	23.5	27	50
1120TR3834	3/8"	3/4"		28	32	50
1120TR12	1/2"	1/2"	14	23.5	27	50
1120TR1234	1/2"	3/4"		28.8	32	50
1120TR34	3/4"	3/4"		30	32	50
1120TR121	1/2"	1"		30.7	38	25
1120TR341	3/4"	1"		31	38	25
1120TR1	1"	1"		33	38	25

prolunga M conico/F cilindrica - *M taper/F parallel extension*

1 1 2 5

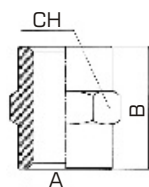

CODE	A	B	CH	
1125TRM5	M5	11	8	100
1125TR18	1/8"	15	14	100
1125TR14	1/4"	22	17	100
1125TR38	3/8"	24	22	100
1125TR12	1/2"	30	26	50
1125TR34	3/4"	29.7	32	50
1125TR1	1"	31.4	38	25

manicotto F/F - *F/F sleeve*

RACCORDI STANDARD IN OTTONE - SERIE 1000

standard fittings in brass

1 126

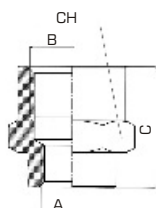

CODE	A	B	C	CH	
1126TRM518	M5	18"	13.5	14	100
1126TR1814	1/8"	1/4"	19	17	100
1126TR1838	1/8"	3/8"	20	22	100
1126TR1812	1/8"	1/2"	24	24	100
1126TR1438	1/4"	3/8"	23	22	100
1126TR1412	1/4"	1/2"	25	24	50
1126TR3812	3/8"	1/2"	27.5	24	50
1126TR3834	3/8"	3/4"	25.7	32	50
1126TR1234	1/2"	3/4"	26	32	50
1126TR121	1/2"	1"	25	38	25
1126TR341	3/4"	1"	25	38	25

manicotto F/F ridotto - *reduced F/F sleeve*

1 130

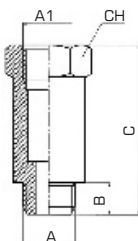

CODE	A	A1	B	C	CH	
1130TR181223	1/8"	1/8"		23	12	100
1130TR181244	1/8"	1/8"		44	12	100
1130TR181422	1/8"	1/8"	6	22	14	100
1130TR181432	1/8"	1/8"	6	32	14	100
1130TR181442	1/8"	1/8"	6	42	14	100
1130TR181451	1/8"	1/8"	6	51	14	100
1130TR141628	1/4"	1/4"		28	16	100
1130TR141645	1/4"	1/4"		45	16	100
1130TR141728	1/4"	1/4"	8	28	17	100
1130TR141735	1/4"	1/4"	8	35	17	100
1130TR141751	1/4"	1/4"	8	51	17	50
1130TR382241	3/8"	3/8"		41	22	50
1130TR122436	1/2"	1/2"		36	24	50
1130TR343050	3/4"	3/4"		50	30	25
1130TR13850	1"	1"		50	38	25

prolunga M/F cilindrica - *M/F parallel extension*

1 135

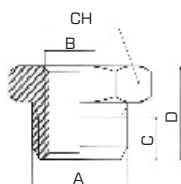

CODE	A	B	C	D	CH	
1135TRM518	1/8"	M5	4.5	10.5	14	100
1135TR1418	1/4"	1/8"	6	13	17	100
1135TR3818	3/8"	1/8"	6.5	14	19	100
1135TR3814	3/8"	1/4"	6.5	14	19	100
1135TR1218	1/2"	1/8"	6.5	15.5	24	100
1135TR1214	1/2"	1/4"	6.5	15.5	24	100
1135TR1238	1/2"	3/8"	6.5	15.5	24	100
1135TR3414	3/4"	1/4"		17	30	50
1135TR3438	3/4"	3/8"		16.7	30	50
1135TR3412	3/4"	1/2"		17.2	30	50
1135TR138	1"	3/8"		19.7	36	25
1135TR112	1"	1/2"		19.7	36	25
1135TR134	1"	3/4"		19.7	36	25

riduzione M/F cilindrica - *M/F parallel reducer*

RACCORDI STANDARD IN OTTONE - SERIE 1000

standard fittings in brass

1140

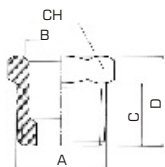

CODE	A	B	C	D	CH	
1140TR1418	1/4"	1/8"	11	16	14	100
1140TR3818	3/8"	1/8"	11.5	16.5	17	100
1140TR3814	3/8"	1/4"	11.5	16.5	17	100
1140TR1218	1/2"	1/8"	14	19.5	22	100
1140TR1214	1/2"	1/4"	14	19.5	22	100
1140TR1238	1/2"	3/8"	14	19.5	22	100
1140TR3414	3/4"	1/4"		20	27	50
1140TR3438	3/4"	3/8"		20	27	50
1140TR3412	3/4"	1/2"	16.5	23.5	27	50
1140TR138	1"	3/8"		21.5	34	25
1140TR112	1"	1/2"		21.9	34	25
1140TR134	1"	3/4"		21.8	34	25

riduzione M/F conico - *M/F taper reducer*

1145

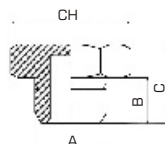

CODE	A	B	C	CH	
1145TRM5	M5	4	7.5	8	100
1145TR18	1/8"	6	10.5	14	100
1145TR14	1/4"	8	13	17	100
1145TR38	3/8"	9	14	19	100
1145TR12	1/2"	10	15.5	24	100
1145TR34	3/4"	11	17	30	50
1145TR1	1"	13	18.5	36	25

tappo M cilindrico - *M parallel plug*

1148

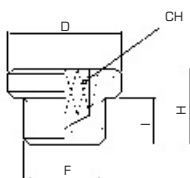

CODE	F	I	H	D	CH	
1148TRM5	M5	4	7.5	8	2,5	100
1148TR18	1/8"	6	10	15	3	100
1148TR14	1/4"	8	12	18	6	100
1148TR38	3/8"	9	13	21	8	100
1148TR12	1/2"	10	14.5	25	10	100

tappo M cilindrico con brugola (no OR) - *M parallel plug with exagon embedded (no OR)*

1149

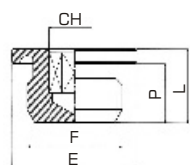

CODE	F	P	L	E	CH	
1149TRM5	M5	4	5.5	8	2,5	100
1149TR18	1/8"	6	8	14	4	100
1149TR14	1/4"	8	10	17	6	100
1149TR38	3/8"	9	12	20	8	100
1149TR12	1/2"	11	14	24	10	100

tappo M cilindrico con brugola e OR - *M parallel plug with exagon embedded and OR*

1150



CODE	A	H	CH	
1150TR18	1/8"	12.2	10	100
1150TR14	1/4"	15.3	14	100
1150TR38	3/8"	16	17	100
1150TR12	1/2"	17.6	22	100
1150TR34	3/4"	19.3	27	50
1150TR1	1"	22	36	25

tappo M conico - *M taper plug*

RACCORDI STANDARD IN OTTONE - SERIE 1000

standard fittings in brass

1 155



CODE	F	I	H	L	CH	
1155TRM5	M5		7		8	100
1155TR18	1/8"	7	13	11.8	12	100
1155TR14	1/4"	8	16	13.8	14	100
1155TR38	3/8"	10	20	16.8	17	100
1155TR12	1/2"	11	23.5	23.8	24	100
1155TR34	3/4"		15		30	50
1155TR1	1"		15		38	25

tappo F cilindrico - *F parallel plug*

1 160



CODE	A	H	CH	
1160TR18	1/8"	7.5	5	100
1160TR14	1/4"	9.7	6	100
1160TR38	3/8"	9.7	8	50
1160TR12	1/2"	10.5	10	50

tappo M brugola cilindrico con invito - *M parallel plug with exagon embedded*

1 161



CODE	A	H	CH	
1161TR18	1/8"	7.6	5	100
1161TR14	1/4"	10.2	6	100
1161TR38	3/8"	10.5	8	50
1161TR12	1/2"	12.6	10	50

tappo M brugola conico piatto - *M taper plug with exagon embedded*

1 165



CODE	F	D Ø	I	H1	H	CH	
1165TRM56	M5	6	4	19	22	8	100
1165TRM57	M5	7	4	19	22.2	8	100
1165TRM66	M6	6	5	19	22	8	100
1165TRM67	M6	7	5	19	22	8	100
1165TR186	1/8"	6	6	19	28	12	100
1165TR187	1/8"	7	6	19	28	12	100
1165TR188	1/8"	8	6	19	28	12	100
1165TR189	1/8"	9	6	19	26.3	12	100
1165TR1810	1/8"	10	6	20	30.5	12	100
1165TR1812	1/8"	12	6	20	30.4	12	100
1165TR146	1/4"	6	8	19	32	14	100
1165TR147	1/4"	7	8	19	32.5	17	100
1165TR148	1/4"	8	8	19	32	17	100
1165TR149	1/4"	9	8	19	32.3	17	100
1165TR1410	1/4"	10	8	20	33	14	100
1165TR1412	1/4"	12	8	20	32.1	17	100
1165TR388	3/8"	8	9	19	33	19	50
1165TR389	3/8"	9	9	19	32	19	50
1165TR3810	3/8"	10	9	20	34	19	50
1165TR3812	3/8"	12	9	20	33.5	19	50
1165TR3814	3/8"	14	9	22	36	19	50
1165TR3817	3/8"	17	9	24	37	19	25
1165TR1212	1/2"	12	10	20	35.5	22	25
1165TR1214	1/2"	14	10	22	37.5	22	25
1165TR1217	1/2"	17	10	24	38.7	24	25
1165TR1219	1/2"	19	10	24	39.5	24	25
1165TR1220	1/2"	20	10	24	39.5	22	25
1165TR3418	3/4"	18	11	24	42	30	25
1165TR3420	3/4"	20	11	24	42	30	25

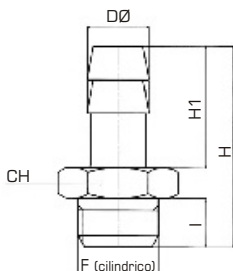

portagomma M cilindrico (no OR) - *M parallel hose adapter (no OR)*

RACCORDI STANDARD IN OTTONE - SERIE 1000

standard fittings in brass

1167

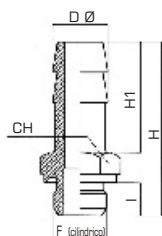

CODE	F	D Ø	I	H1	H	CH	
1167TR186	1/8"	6	6.5		30	14	100
1167TR187	1/8"	7	6	20	31.5	13	100
1167TR188	1/8"	8	6.5		30	14	100
1167TR189	1/8"	9	6	20	31.5	13	100
1167TR146	1/4"	6	8		32	17	100
1167TR147	1/4"	7	8	20	34	16	100
1167TR149	1/4"	9	8	20	34	16	100
1167TR1412	1/4"	12	8	20	34	16	100
1167TR389	3/8"	9	9	20	35	17	50
1167TR3812	3/8"	12	9	20	36	17	50
1167TR3817	3/8"	17	9		38	20	25
1167TR1212	1/2"	12	11	20	37	22	25
1167TR1217	1/2"	17	11	20	37	22	25
1167TR1218	1/2"	18	11	20	37	22	25

portagomma M cilindrico con OR - *M parallel hose adapter with OR*

1169

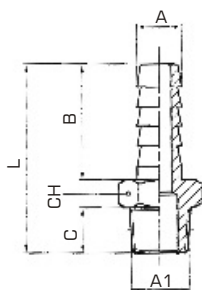

CODE	A1	A	B	C	L	CH	
1169TR186	1/8"	6	19	8	31.5	12	100
1169TR187	1/8"	7	19	8	31.5	12	100
1169TR188	1/8"	8	19	8	31.5	12	100
1169TR189	1/8"	9	19	8	31.5	12	100
1169TR1810	1/8"	10	20	8	32.5	12	100
1169TR146	1/4"	6	19	11	35	14	100
1169TR147	1/4"	7	19	11	35	14	100
1169TR148	1/4"	8	19	11	35	14	100
1169TR149	1/4"	9	19	11	35	14	100
1169TR1410	1/4"	10	20	11	36	14	100
1169TR1412	1/4"	12	20	11	36	14	100
1169TR389	3/8"	9	19	11.5	35.5	17	50
1169TR3810	3/8"	10	20	11.5	36.5	17	50
1169TR3812	3/8"	12	20	11.5	36.5	17	50
1169TR3814	3/8"	14	22	11.5	38.5	17	50
1169TR3816	3/8"	16	22	11.5	38.5	17	50
1169TR3817	3/8"	17	24	11.5	40.5	18	25
1169TR3818	3/8"	18	24	11.5	40.5	19	25
1169TR3820	3/8"	20	24	11.5	41	21	25
1169TR129	1/2"	9	19	14	38.5	22	25
1169TR1210	1/2"	10	20	14	39.5	22	25
1169TR1212	1/2"	12	20	14	39.5	22	25
1169TR1214	1/2"	14	22	14	41.5	22	25
1169TR1216	1/2"	16	22	14	41.5	22	25
1169TR1217	1/2"	17	24	14	43.5	22	25
1169TR1218	1/2"	18	24	14	43.5	22	25
1169TR1220	1/2"	20	24	14	43.5	22	25
1169TR3416	3/4"	16	22	16.5	45	27	25
1169TR3418	3/4"	18	24	16.5	47	27	25
1169TR3420	3/4"	20	24	16.5	46.5	27	25
1169TR3425	3/4"	25	30	16.5	53	27	25
1169TR125	1"	25	30	19	56	34	25

portagomma M conico - *M taper hose adapter*

1170

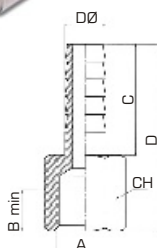

CODE	A	D Ø	B	C	D	CH	
1170TR187	1/8"	7	7	19	32	12	100
1170TR188	1/8"	8	8	28	38.5	12	100
1170TR189	1/8"	9	8	26.3	36.8	12	100
1170TR147	1/4"	7	10	32.5	45.5	17	100
1170TR148	1/4"	8	10	32	45	17	100
1170TR149	1/4"	9	10	19	35	17	100
1170TR1412	1/4"	12	10	32.1	45.1	17	100

portagomma femmina - *F hose adapter*

RACCORDI STANDARD IN OTTONE - SERIE 1000

standard fittings in brass

1175



CODE	D	H	CH	
1175TRM5	M5	2,5	9	100
1175TR18	1/8"	3,4	12	100
1175TR14	1/4"	5	17	100
1175TR38	3/8"	4	19	50
1175TR12	1/2"	6	24	50
1175TR34	3/4"	5	30	20
1175TR1	1"	6	38	10

dado - nut

1200

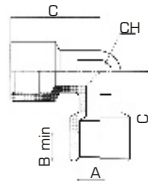

CODE	A	B	C	CH	
1200TRM5	M5	3	11	9	100
1200TR18	1/8"	7	20	10	100
1200TR14	1/4"	8	25.5	13	100
1200TR38	3/8"	10	29	17	50
1200TR12	1/2"	11	36	20	50
1200TR34	3/4"	16.5	36.5	25	25
1200TR1	1"	19	45	30	10

curva F/F cilindrica - F/F parallel elbow

1205

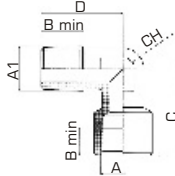

CODE	A	A1	B	B1	C	D	CH	
1205TRM5	M5	M5	5	4	11	11.5	9	100
1205TR18	1/8"	1/8"	7	8	20	19	10	100
1205TR14	1/4"	1/4"	8	11	25.5	24	13	100
1205TR38	3/8"	3/8"	10	11.5	29	26.5	17	50
1205TR12	1/2"	1/2"	11	14	35	31.5	20	50
1205TR34	3/4"	3/4"	6.5	16	36.5	33	25	25
1205TR1	1"	1"	19	17.5	39	45	30	10

curva F/M conica - F/M taper elbow

1210

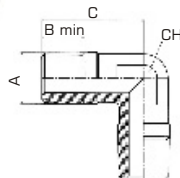

CODE	A	B	C	CH	
1210TRM5	M5	4	11.9	8	100
1210TR18	1/8"	8	19	10	100
1210TR14	1/4"	12.5	24	13	100
1210TR38	3/8"	13.6	26.5	17	50
1210TR12	1/2"	15.5	31.5	20	50
1210TR34	3/4"	16	33	25	25
1210TR1	1	17.5	39	30	10

curva M/M conica - M/M taper elbow

1215

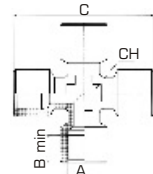

CODE	A	B	C	CH	
1215TR18	1/8"	7	40	10	100
1215TR14	1/4"	8	51	13	50
1215TR38	3/8"	10	58	17	50
1215TR12	1/2"	11	72	20	25

raccordo a croce F - F equal cross

RACCORDI STANDARD IN OTTONE - SERIE 1000

standard fittings in brass

1216

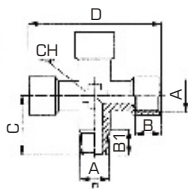

CODE	A	Ø	B	C	D	CH	
1216TR18	1/8"	7	8	19	40	10	100
1216TR14	1/4"	8	12.5	24	51	13	100
1216TR38	3/8"	10	13.6	26.5	58	17	50
1216TR12	1/2"	11	15.5	31.5	72	20	25

raccordo a croce M/F/F/F - *M/F/F/F equal cross*

1220

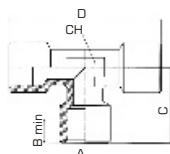

CODE	A	B	C	D	CH	
1220TRM5	M5	5	11	22	9	100
1220TR18	1/8"	7	20	40	10	100
1220TR14	1/4"	8	25.5	51	13	50
1220TR38	3/8"	10	29	58	17	50
1220TR12	1/2"	11	36	72	20	25
1220TR34	3/4"	16.5	36.5	73	25	20
1220TR1	1"	19	45	90	30	10

raccordo a T F - *female tee*

1225

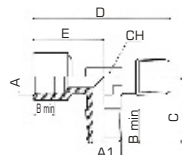

CODE	A	A1	B	B1	C	D	E	CH	
1225TR18	1/8"	1/8"	7	8	19	39	20	10	100
1225TR14	1/4"	1/4"	8	12.5	24	49.5	25.5	13	100
1225TR38	3/8"	3/8"	10	13.6	26.5	55.5	29	17	50
1225TR12	1/2"	1/2"	11	15.5	31.5	67.5	36	20	25
1225TR34	3/4"	3/4"	16.5		33	69.5	33	25	20
1225TR1	1"	1"	19		39	84	39	30	10

raccordo a T F/M/M - *lateral F/M/M tee*

1230

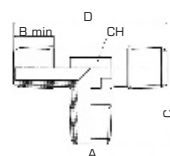

CODE	A	B	C	D	CH	
1230TR18	1/8"	8	19	10	10	100
1230TR14	1/4"	12.5	24	48	13	100
1230TR38	3/8"	13.6	26.5	53	17	50
1230TR12	1/2"	15.5	31.5	63	20	50
1230TR34	3/4"	16	33	66.4	25	20
1230TR1	1"	17.5	39	78	30	10

raccordo a T M - *male tee*

1235

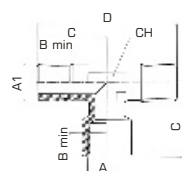

CODE	A	A1	B	B1	C	D	E	CH	
1235TR18	1/8"	1/8"	7	8	19	38	20	10	100
1235TR14	1/4"	1/4"	8	12.5	24	48	25.5	13	100
1235TR38	3/8"	3/8"	10	13.6	26.5	53	29	17	50
1235TR12	1/2"	1/2"	11	15.5	31.5	63	36	20	25
1235TR34	3/4"	3/4"	16.5	16.2		66.4	36.5	25	20
1235TR1	1"	1"	19	17.5		78	45	30	10

raccordo a T M/F/M - *M/F/M central tee*

RACCORDI STANDARD IN OTTONE - SERIE 1000

standard fittings in brass

1240

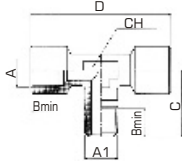

CODE	A	A1	B	B1	C	D	CH	
1240TRM5	M5	M5	5	4	11.5	22	9	100
1240TR18	1/8"	1/8"	7	8	19	40	10	100
1240TR14	1/4"	1/4"	8	11	24	51	13	50
1240TR38	3/8"	3/8"	10	13.6	26.5	58	17	50
1240TR12	1/2"	1/2"	11	15.5	31.5	72	20	25
1240TR34	3/4"	3/4"	16.5	16	33	73	25	20
1240TR1	1"	1"	19	17.5	39	90	30	10

raccordo a T F/M/F - *F/M/F central tee*

1245

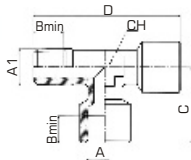

CODE	A	A1	B	B1	C	D	CH	
1245TRM5	M5	M5	5	4	11	22.5	9	100
1245TR18	1/8"	1/8"	7	8	20	39	10	100
1245TR14	1/4"	1/4"	8	11	25.5	49.5	13	50
1245TR38	3/8"	3/8"	10	13.6	29	55.5	17	50
1245TR12	1/2"	1/2"	11	15.5	35	66.5	20	25
1245TR34	3/4"	3/4"	16.5	16	36.5	69.5	25	20
1245TR1	1"	1"	19	17.5	45	84	30	10

raccordo a T F/F/M - *F/F/M lateral tee*

1260

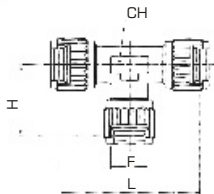

CODE	F	H	L	CH	
1260TR14	1/4"	25,3	50.6	13	10

attacco baionetta/ghiera a T - *tee with milled nut*

1265

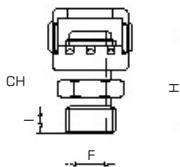

CODE	F	I	H	CH	
1265TR14	1/4"	10	28.5	15	10
1265TR38	3/8"	10	28.5	17	10

diritto M attacco baionetta/ghiera - *male with milled nut*

1270

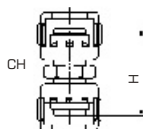

CODE		H	CH	
1270TR14	1/4"	32	15	10

diritto intermedio attacco baionetta/ghiera - *double milled nut*

RACCORDI STANDARD IN OTTONE - SERIE 1000

standard fittings in brass

1300

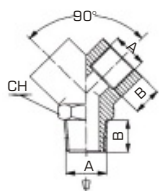

CODE	A	B	CH	
1300TR18	1/8"	8	13	50
1300TR14	1/4"	11	17	50
1300TR38	3/8"	11.5	20	25
1300TR12	1/2"	14	25	20

raccordo a Y F/M/F - *F/M/F Y*

1310

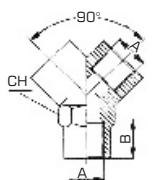

CODE	A	B	CH	
1310TR18	1/8"	8	13	50
1310TR14	1/4"	11	17	50
1310TR38	3/8"	11.5	20	25
1310TR12	1/2"	14	25	20

raccordo a Y F/F/F - *F/F/F Y*

1320

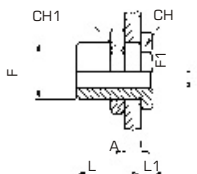

CODE	F1	F	A	L	L1	CH	Ch1	
1320TRM5M101	M5	M10x1	7	10.5	3.5	14	14	100
1320TR18M1615	1/8"	M16x1.5	10	14	4	19	22	100
1320TR14M2015	1/4"	M20x1.5	16	21	4	24	27	50
1320TR38M2615	3/8"	M26x1.5	15	21	5	30	32	30
1320TR12M2815	1/2"	M28x1.5	21	27	6	32	36	20

passaparete F/F - *F/F bulkhead connector*

1600



CODE	A	B	L	CH	
1600TRM518	M5	1/8"	8	3	200
1600TR1418	1/4"	1/8"	9	6	100
1600TR3818	3/8"	1/8"	9.5	6	100
1600TR3814	3/8"	1/4"	9.5	8	100
1600TR1214	1/2"	1/4"	10	10	50
1600TR1238	1/2"	3/8"	10	10	50
1600TR3412	3/4"	1/2"	13	12	20
1600TR134	1"	3/4"	15	17	10

riduzione a brugola a scomparsa - *exagon embedded reducer*

