

BRASS PUSH-IN FITTINGS

PLUS

HIGH PERFORMANCE FITTINGS,
easy to be used

STRONG but also compact in order to ensure
the maximum assembling flexibility

SILICON FREE MATERIALS

IN COMPLIANCE WITH ISO 14743

COMPLETE RANGE suitable to be used with
different kind of tubing

ELECTROLYTIC NICKEL PLATING
to ensure the maximum lasting in time

**SUITABLE WITH VACUUM
APPLICATIONS**

STATIC GRIPPING SYSTEM in order
to stop all the movements of the tube when
inserted, granting **A LEAK-PROOF
CONNECTION**

Every fitting is **STUDIED TO GUARANTEE
THE MAXIMUM POSSIBLE FLOW
RATE** accordingly to the diameter of the tube
and of the thread

O-RING WITH ENLARGED SECTION
to improve the gripping and the resistance to
vibrations and lateral movements of the tube

M A D E I N I T A L Y

					
p. 8 / OTRC-R	p. 8 / OTRC-G	p. 9 / OTRC-N	p. 9 / OTROC-N	p. 9 / OTRMM	p. 10 / OTRME
					
p. 10 / OTRL-R	p. 10 / OTRL-G	p. 11 / OTRL-N	p. 11 / OTRT-R	p. 12 / OTRT-G	p. 12 / OTRT-N
					
p. 13 / OTA-G	p. 13 / OTRUC	p. 13 / OTRUC-N	p. 14 / OTRUL	p. 14 / OTRUL-N	p. 14 / OTRUT
					
p. 14 / OTRUT-N	p. 15 / OTRGJ				

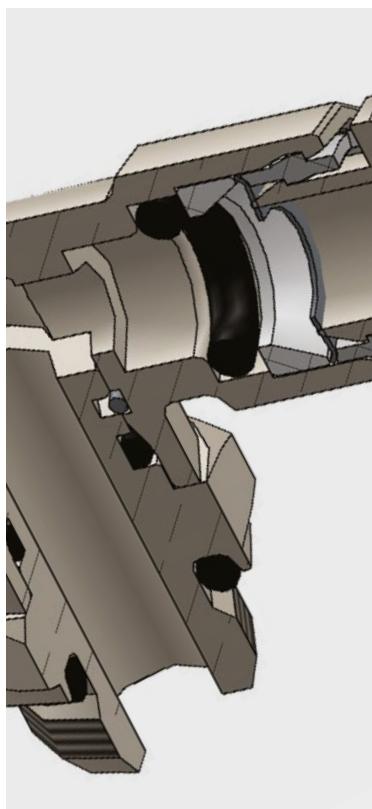

-20°C ÷ 80°C



Working pressure:

16 Bar

Negative pressure:

- 750 mmHg (- 0,999 Bar)



Compressed air and vacuum



Taper gas BSPT ISO 7

from R1/8" to R1/2"

Parallel gas BSPP ISO 228

from G1/8" to G1/2"

Metric ISO 262 M5 and M7

NPT ANSI B 1.20.1

from N1/8" to N1/2"

UNF ANSI B 1.1 10-32 UF



Polyamide, Polyurethane,
Polyethylene

Body: nickel plated brass

UNI EN 12164 CW614N & UNI EN
12164 CW617N

Collar: POM

Collet (sleeve): nickel plated brass

UNI EN 12164 CW614N

Seals: NBR silicon free

Lock claw: AISI 301 stainless steel

Back ring: PBT

Retaining ring for swivel systems:

AISI 302 stainless steel



Products in compliance with
the directive 1907/2006



RoHS2

Products in compliance with
the directive 2011/65/EU

SILICON FREE

CONSTRUCTION DETAILS

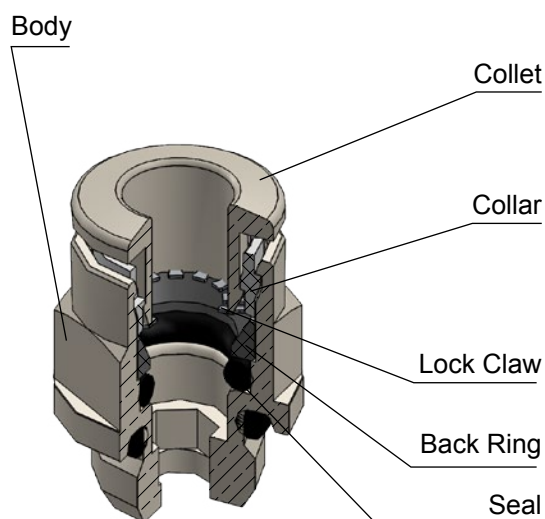
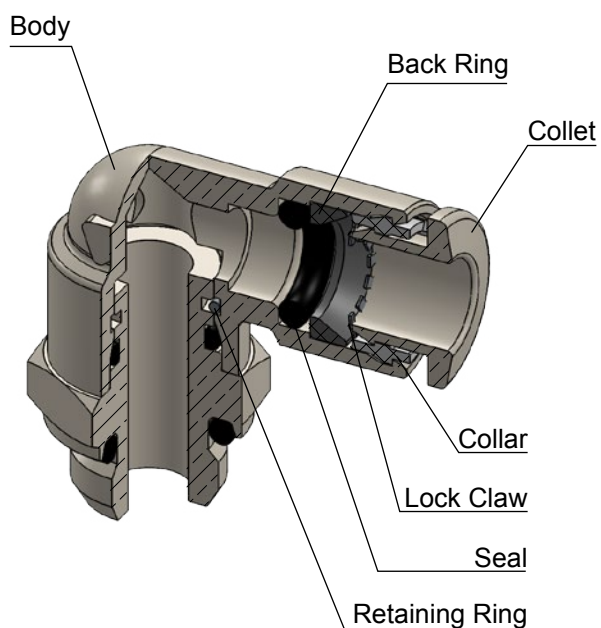

INSERTION OF THE TUBE INTO THE FITTING

- Make sure the tube is fully inserted into the fitting.
- To insert the tube into the fitting cut the tube off square (90°), insert tube up to the fitting end stop, and pull back gently to make sure it is correctly connected.
- If there is any damage or scratches on the tube surface the tube is an oval shape, air leakage and tube release may occur. Check the tube condition carefully.
- The OD of polyurethane tube expands when pressure is applied. Reinsertion into the fitting may not always be possible. Check the OD of the tube and renew it the expansion is out of tolerance.

DISCONNECTION OF THE TUBE FROM THE FITTING

- Make sure the pressure in the system is zero before releasing the tube from the fitting.
- To release the tube, press the release sleeve towards the fitting with one hand and pull the tube away from the fitting with the other hand.
- Always remove the section of tube previously inserted into the fitting before reinserting the tube by cutting back the tube. Always use the correct tube cutter in order to cut the tube square and free of damage.

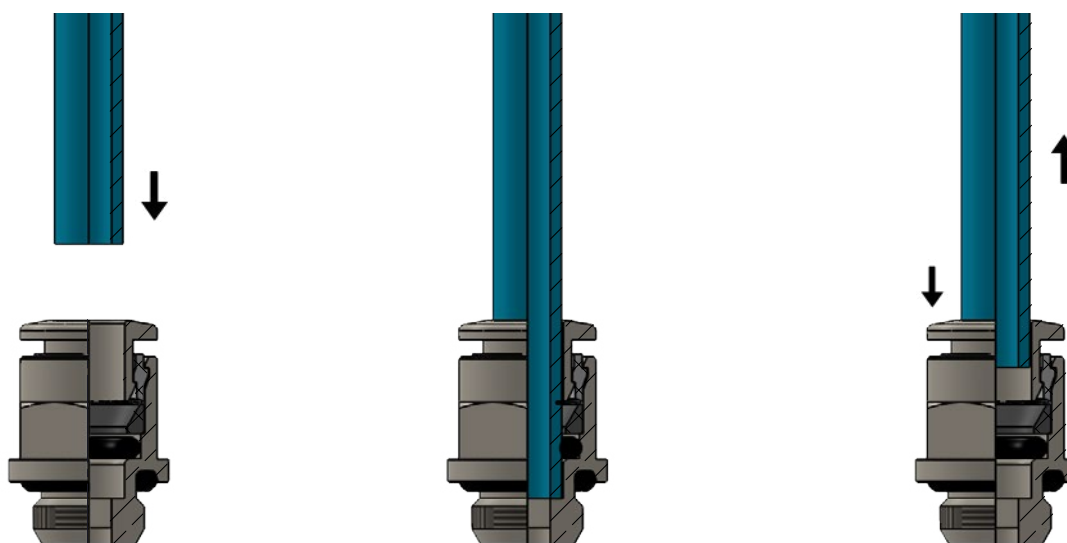

TOLERANCE - METRIC TUBE

Ø TUBE (mm)	4	6	8	10	12
TOLERANCE (mm)	± 0,1	± 0,1	± 0,1	± 0,15	± 0,15

INSERTION - METRIC TUBE

Ø TUBE (mm)	4	6	8	10	12
TUBE INSERTION LENGTH (mm)	14	15,5	17,5	19	21

TOLERANCE - INCH TUBE

Ø TUBE	5/32	1/4	5/16	3/8	1/2
TOLERANCE (Inch)	±0,004	±0,004	±0,004	± 0,006	± 0,006

INSERTION - INCH TUBE

Ø TUBE	5/32	1/4	5/16	3/8	1/2
TUBE INSERTION LENGTH (Inch)	0,551	0,629	0,688	0,728	0,846

OTRC-R

Male connector internal hexagonal BSPT thread nickel plated

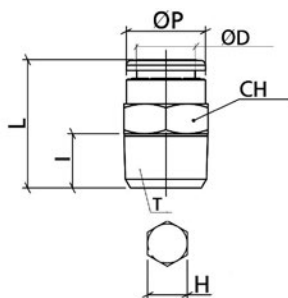

CODE	ØD	T	ØP	I	L	CH	H	WEIGHT G
OTRC04R01	4	R1/8"	10	8	18,5	10	3	7,0
OTRC04R02		R1/4"	10	10	20	14	3	15,0
OTRC06R01	6	R1/8"	12	8	21	12	4	9,0
OTRC06R02		R1/4"	12	10	20	14	4	14,0
OTRC08R01	8	R1/8"	14	8	26	14	5	15,0
OTRC08R02		R1/4"	14	10	24	14	6	14,0
OTRC08R03		R3/8"	14	11	22	17	6	24,0
OTRC10R02	10	R1/4"	16	10	31	16	6	22,0
OTRC10R03		R3/8"	16	11	26	17	8	23,0
OTRC10R04		R1/2"	16	14	26,5	22	8	45,0
OTRC12R02	12	R1/4"	19	10	33	19	6	21,0
OTRC12R03		R3/8"	19	11	29,5	19	10	27,0
OTRC12R04		R1/2"	19	14	27	22	10	44,5

OTRC-G

Male connector internal hexagonal BSPP & metric thread nickel plated

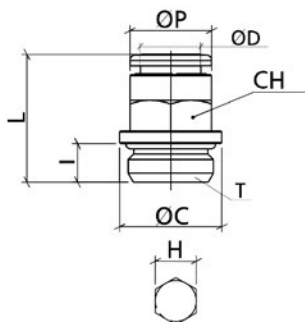

CODE	ØD	T	ØP	ØC	I	L	CH	H	WEIGHT G
OTRC04M5	4	M5X0,8	10	7	4	19	9	2,5	5,0
OTRC04G01		G1/8"	10	14	5,5	18	10	3	8,0
OTRC04G02		G1/4"	10	16	6,5	18	10	3	11,0
OTRC06M5	6	M5X0,8	12	7	4	21	11	2,5	8,0
OTRC06G01		G1/8"	12	14	5,5	19,5	12	4	9,0
OTRC06G02		G1/4"	12	16	6,5	19,5	12	4	12,0
OTRC08G01	8	G1/8"	14	14	5,5	24,5	14	5	14,0
OTRC08G02		G1/4"	14	16	6,5	21,5	14	6	13,5
OTRC08G03		G3/8"	14	20	7,5	21,5	14	6	20,0
OTRC10G02	10	G1/4"	16	16	6,5	27,5	16	6	19,0
OTRC10G03		G3/8"	16	20	7,5	25	16	8	22,0
OTRC10G04		G1/2"	16	25	9	25	16	8	33,0
OTRC12G02	12	G1/4"	19	16	6,5	30	19	6	28,0
OTRC12G03		G3/8"	19	22	7,5	29,5	19	10	30,0
OTRC12G04		G1/2"	19	25	9	28	19	10	37,0

OTRC-N

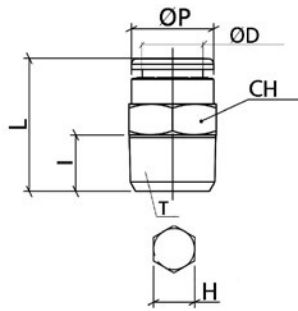

Male connector internal hexagonal NPT thread nickel plated

CODE	ØD	T	ØP	I	L	CH	H	WEIGHT G
OTRC532N01	5/32"	N1/8"	0,393	0,334	0,748	7/16"	1/8"	9,0
OTRC532N02		N1/4"	0,393	0,413	0,787	9/16"	1/8"	16,0
OTRC1-4N01	1/4"	N1/8"	0,511	0,334	0,885	1/2"	3/16"	11,0
OTRC1-4N02		N1/4"	0,511	0,413	0,885	9/16"	3/16"	15,0
OTRC516N01	5/16"	N1/8"	0,551	0,334	1,062	9/16"	3/16"	15,5
OTRC516N02		N1/4"	0,551	0,413	1,003	9/16"	1/4"	16,0
OTRC516N03		N3/8"	0,551	0,452	0,925	11/16"	1/4"	25,0
OTRC38N01	3/8"	N1/8"	0,629	0,334	1,122	11/16"	3/16"	21,5
OTRC38N02		N1/4"	0,629	0,413	1,181	11/16"	1/4"	25,0
OTRC38N03		N3/8"	0,629	0,452	1,003	11/16"	5/16"	24,0
OTRC38N04		N1/2"	0,629	0,570	1,043	7/8"	5/16"	46,0
OTRC1-2N02	1/2"	N1/4"	0,748	0,413	1,318	7/8"	1/4"	37,0
OTRC1-2N03		N3/8"	0,748	0,452	1,338	7/8"	3/8"	39,0
OTRC1-2N04		N1/2"	0,748	0,570	1,181	7/8"	3/8"	43,0

OTROC-N

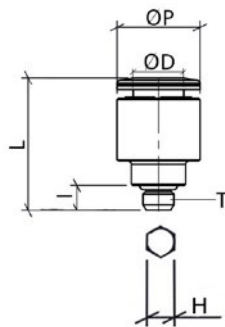

Male connector internal hexagon UNF thread nickel plated

CODE	ØD	T	ØP	I	L	H	WEIGHT G
OTROC532UF1032	5/32"	UNF 10-32	0,393	0,157	0,748	3/32"	12,0
OTROC1-4UF1032	1/4"	UNF 10-32	0,511	0,157	0,846	3/32"	16,0

OTRMM

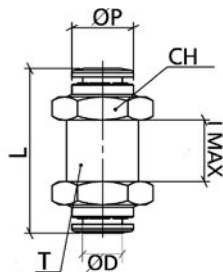

Bulkhead connector nickel plated

CODE	ØD	T	ØP	L	I MAX	CH	WEIGHT G
OTRMM04-532	4	M12X1	10	30	12	16	23,0
OTRMM0600	6	M14X1	12	35,5	15	17	31,0
OTRMM08-516	8	M16X1	14	36,5	16	19	36,0
OTRMM1000	10	M20X1	16	43	19	24	70,0
OTRMM1200	12	M22X1,5	19	44	20	25	76,0

OTRME

Male elbow BSPT thread nickel plated

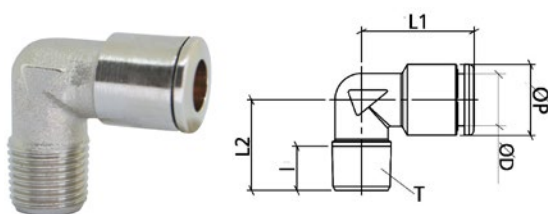

CODE	ØD	T	ØP	I	L1	L2	WEIGHT G
OTRME04R01	4	R1/8"	10	8	18	15,5	11,0
OTRME06R01	6	R1/8"	12	8	19,5	15,5	15,0
OTRME06R02		R1/4"	12	10	20,5	19,25	25,0
OTRME08R01	8	R1/8"	14	8	22,5	16,5	20,0
OTRME08R02		R1/4"	14	10	22,5	19,25	24,0
OTRME10R02	10	R1/4"	16	10	25,5	20,5	26,0

OTRL-R

Swivel male elbow BSPT thread nickel plated

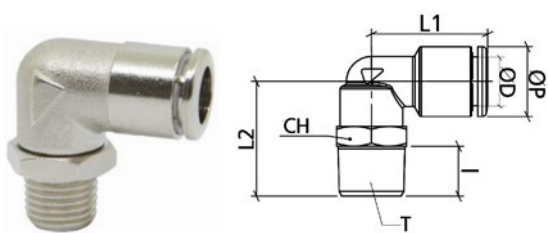

CODE	ØD	T	ØP	I	L1	L2	CH	WEIGHT G
OTRLO4R01	4	R1/8"	10	8	19,5	20,5	13	20,0
OTRLO4R02		R1/4"	10	10	19,5	23	14	23,0
OTRLO6R01	6	R1/8"	12	8	21	20,5	13	20,0
OTRLO6R02		R1/4"	12	10	21	23	14	24,0
OTRLO8R01	8	R1/8"	14	8	23	20,5	13	22,0
OTRLO8R02		R1/4"	14	10	23	23	14	26,0
OTRLO8R03		R3/8"	14	11	23	24,5	17	32,0
OTRL10R02	10	R1/4"	16	10	26	25,5	16	41,0
OTRL10R03		R3/8"	16	11	26	27	17	45,0
OTRL10R04		R1/2"	16	14	26	30	22	59,0
OTRL12R02	12	R1/4"	19	10	31	28	20	56,0
OTRL12R03		R3/8"	19	11	31	28,5	20	59,0
OTRL12R04		R1/2"	19	14	31	31,5	22	70,0

OTRL-G

Swivel male elbow BSPP & metric nickel plated

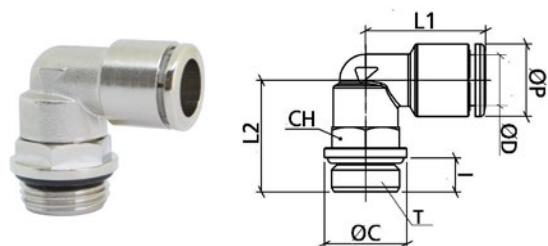

CODE	ØD	T	ØP	ØC	I	L1	L2	CH	WEIGHT G
OTRLO4M5	4	M5X0,8	10	7	4	18	15	8	5,0
OTRLO4G01		G1/8"	10	13	5,5	19,5	19	13	19,0
OTRLO4G02		G1/4"	10	16	6,5	19,5	21,5	13	22,0
OTRLO6M5	6	M5X0,8	12	7	4	19,5	16	8	11,0
OTRLO6G01		G1/8"	12	13	5,5	21	19	13	20,0
OTRLO6G02		G1/4"	12	16	6,5	21	21,5	13	24,0
OTRLO8G01	8	G1/8"	14	13	5,5	23	19	13	22,0
OTRLO8G02		G1/4"	14	16	6,5	23	21,5	13	24,0
OTRLO8G03		G3/8"	14	20	7,5	23	23	13	28,0
OTRL10G02	10	G1/4"	16	16	6,5	26	23	16	35,0
OTRL10G03		G3/8"	16	20	7,5	26	26	16	43,5
OTRL10G04		G1/2"	16	25	9	26	27,5	16	52,0
OTRL12G02	12	G1/4"	19	16	6,5	31	25,5	20	55,0
OTRL12G03		G3/8"	19	20	7,5	31	26,5	20	55,0
OTRL12G04		G1/2"	19	25	9	31	29	20	63,0

OTRL-N

Swivel male elbow NPT & UNF thread nickel plated

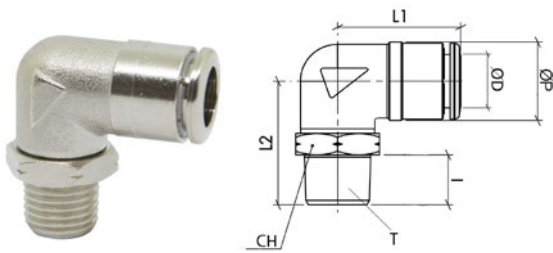

CODE	ØD	T	ØP	I	L1	L2	CH	WEIGHT G
OTRL532UF1032	5/32"	UNF 10/32	0,394	0,157	0,709	0,591	3/8"	11,0
OTRL532N01		N1/8"	0,394	0,334	0,768	0,827	9/16"	20,5
OTRL532N02		N1/4"	0,394	0,413	0,768	0,925	9/16"	24,0
OTRL1-4N01	1/4"	N1/8"	0,512	0,334	0,846	0,827	9/16"	23,0
OTRL1-4N02		N1/4"	0,512	0,413	0,846	0,925	9/16"	26,0
OTRL516N01	5/16"	N1/8"	0,551	0,334	0,906	0,827	9/16"	23,0
OTRL516N02		N1/4"	0,551	0,413	0,906	0,925	9/16"	24,0
OTRL516N03		N3/8"	0,551	0,452	0,906	0,984	11/16"	34,0
OTRL38N01	3/8"	N1/8"	0,650	0,334	1,004	0,945	11/16"	40,0
OTRL38N02		N1/4"	0,650	0,413	1,004	1,024	11/16"	43,0
OTRL38N03		N3/8"	0,650	0,452	1,024	1,083	11/16"	47,0
OTRL38N04		N1/2"	0,650	0,570	1,004	1,201	7/8"	60,0
OTRL1-2N02	1/2"	N1/4"	0,768	0,413	1,220	1,122	7/8"	58,0
OTRL1-2N03		N3/8"	0,768	0,452	1,220	1,161	7/8"	61,0
OTRL1-2N04		N1/2"	0,768	0,570	1,220	1,280	7/8"	67,0

OTRT-R

Swivel male tee BSPT thread nickel plated

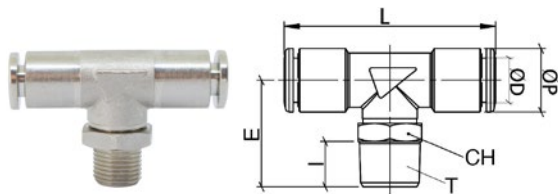

CODE	ØD	T	ØP	I	E	L	CH	WEIGHT G
OTRT04R01	4	R1/8"	10	8	21	39	13	27,0
OTRT04R02		R1/4"	10	10	23,5	39	14	31,0
OTRT06R01	6	R1/8"	12	8	21	42	13	30,0
OTRT06R02		R1/4"	12	10	23,5	42	14	34,0
OTRT08R01	8	R1/8"	14	8	21	46,5	13	34,0
OTRT08R02		R1/4"	14	10	23,5	46,5	14	37,0
OTRT08R03		R3/8"	14	11	25	46,5	17	44,0
OTRT10R02	10	R1/4"	16	10	25,5	52	16	55,0
OTRT10R03		R3/8"	16	11	27	52	17	58,5
OTRT10R04		R1/2"	16	14	30	52	22	73,0
OTRT12R02	12	R1/4"	19	10	28	62	20	77,0
OTRT12R03		R3/8"	19	11	28,5	62	20	80,0
OTRT12R04		R1/2"	19	14	31,5	62	22	81,0

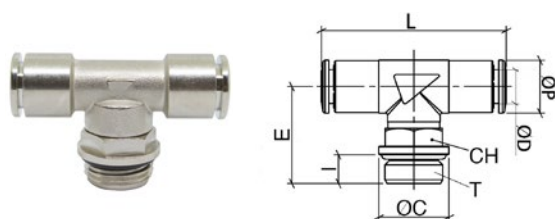
OTRT-G**Swivel male tee BSPP & metric thread nickel plated**

CODE	ØD	T	ØP	I	E	L	CH	WEIGHT G
OTRT04M5	4	M5X0,8	10	4	17	32	8	17,0
OTRT04G01		G1/8"	10	5,5	19,5	39	13	29,0
OTRT04G02		G1/4"	10	6,5	22	39	13	29,0
OTRT06M5	6	M5X0,8	12	4	17	40	8	21,0
OTRT06G01		G1/8"	12	5,5	19,5	42	13	29,0
OTRT06G02		G1/4"	12	6,5	22	42	13	32,0
OTRT08G01	8	G1/8"	14	5,5	19,5	46,5	13	33,0
OTRT08G02		G1/4"	14	6,5	22	46,5	13	35,5
OTRT08G03		G3/8"	14	7,5	23,5	46,5	13	39,0
OTRT10G02	10	G1/4"	16	6,5	23	52	16	52,0
OTRT10G03		G3/8"	16	7,5	26	52	16	56,0
OTRT10G04		G1/2"	16	9	27,5	52	16	64,5
OTRT12G02	12	G1/4"	19	6,5	25,5	62	20	75,0
OTRT12G03		G3/8"	19	7,5	26,5	62	20	77,0
OTRT12G04		G1/2"	19	9	29	62	20	82,0

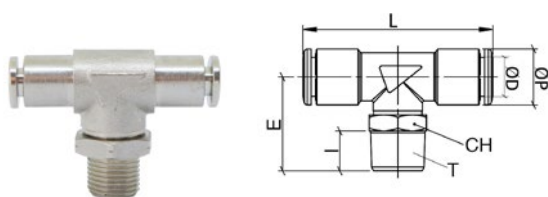
OTRT-N**Swivel male tee NPT & UNF thread nickel plated**

CODE	ØD	T	ØP	I	E	L	CH	WEIGHT G
OTRT532UF1032	5/32"	UNF 10-32	0,393	0,157	0,669	1,259	3/8"	17,0
OTRT532N01		N1/8"	0,393	0,334	0,846	1,535	9/16"	28,0
OTRT532N02		N1/4"	0,393	0,413	0,944	1,535	9/16"	31,0
OTRT1-4N01	1/4"	N1/8"	0,551	0,334	0,846	1,673	9/16"	33,0
OTRT1-4N02		N1/4"	0,551	0,413	0,944	1,673	9/16"	36,0
OTRT516N01	5/16"	N1/8"	0,551	0,334	0,846	1,830	9/16"	34,0
OTRT516N02		N1/4"	0,551	0,413	0,944	1,830	9/16"	37,0
OTRT38N02	3/8"	N1/4"	0,649	0,413	1,023	2,027	11/16"	58,0
OTRT38N03		N3/8"	0,649	0,452	1,082	2,027	11/16"	61,0
OTRT1-2N02	1/2"	N1/4"	0,767	0,413	1,122	2,440	7/8"	75,0
OTRT1-2N03		N3/8"	0,767	0,452	1,161	2,440	7/8"	78,0

OTA-G

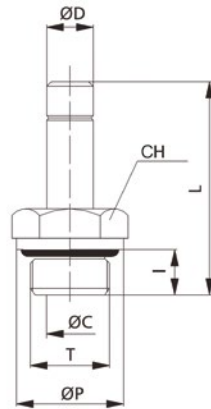

Stem adapter BSPP & metric thread nickel plated

CODE	ØD	T	ØP	ØC	I	L	CH	DN	WEIGHT G
OTA04M5	4	M5	8,0	2,0	4,0	24,5	8	2,0	3,0
OTA04M7		M7	-	4,0	6,0	26,0	10	2,0	5,0
OTA04G01		G1/8"	13,0	6,0	6,0	28,0	13	2,0	10,0
OTA04G02		G1/4"	16,0	7,5	8,0	30,0	13	2,0	11,0
OTA06M5	6	M5	8,0	2,6	4,0	26,0	8	2,6	5,0
OTA04M7		M7	-	4,0	6,0	28,0	10	4,0	7,0
OTA06G01		G1/8"	13,0	6,0	6,0	29,5	13	4,0	9,0
OTA06G02		G1/4"	16,0	7,5	8,0	32,0	13	4,0	13,0
OTA08G01	8	G1/8"	13,0	6,0	6,0	31,0	13	6,0	10,0
OTA08G02		G1/4"	16,0	7,5	8,0	33,5	13	6,0	13,0
OTA08G03		G3/8"	20,0	9,0	9,0	35,5	13	6,0	21,0
OTA10G01	10	G1/8"	13,0	6,0	6,0	35,5	13	6,0	17,0
OTA10G02		G1/4"	16,0	8,0	8,0	38,0	13	8,0	15,0
OTA10G03		G3/8"	20,0	8,0	9,0	41,0	13	8,0	26,0
OTA12G02	12	G1/4"	16,0	8,0	8,0	39,0	13	8,0	22,0
OTA12G03		G3/8"	20,0	11,0	9,0	42,0	13	10,0	22,0
OTA12G04		G1/2"	24,0	13,0	11,0	44,0	16	10,0	35,0

OTRUC

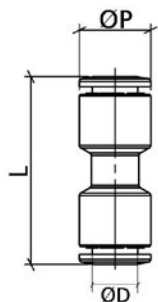

Union connector metric tube nickel plated

CODE	ØD	ØP	L	WEIGHT G
OTRUC04-532	4	10	29	9,0
OTRUC0600	6	12	32	12,0
OTRUC08-516	8	14	35,5	16,0
OTRUC1000	10	16	39,5	21,0
OTRUC1200	12	19	44	37,0

OTRUC-N

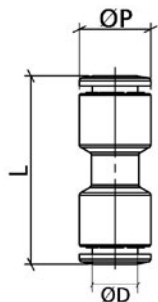

Union connector inch tube nickel plated

CODE	ØD	ØP	L	WEIGHT G
OTRUC04-532	5/32"	0,393	1,141	9,0
OTRUC1-4	1/4"	0,511	1,299	14,0
OTRUC08-516	5/16"	0,551	1,397	16,0
OTRUC38	3/8"	0,629	1,515	21,0
OTRUC1-2	1/2"	0,748	1,732	37,0



OTRUL

Union elbow metric tube nickel plated

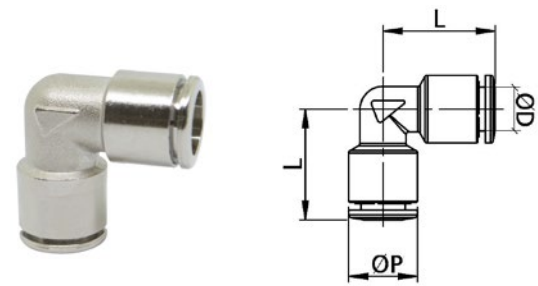

CODE	ØD	ØP	L	WEIGHT G
OTRUL04-532	4	10	18	12,0
OTRUL0600	6	12	19,5	14,0
OTRUL08-516	8	14	22,5	20,0
OTRUL1000	10	16	25,5	26,0
OTRUL1200	12	19	29	49,0

OTRUL-N

Union elbow inch tube nickel plated

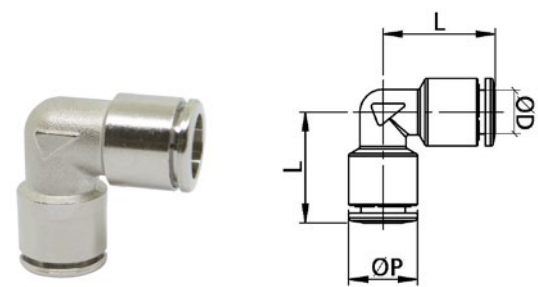

CODE	ØD	ØP	L	WEIGHT G
OTRUL04-532	5/32"	0,393	0,708	12,0
OTRUL1-4	1/4"	0,551	0,826	19,0
OTRUL08-516	5/16"	0,551	0,885	20,0
OTRUL38	3/8"	0,649	0,984	28,0
OTRUL1-2	1/2"	0,767	1,122	43,0

OTRUT

Union tee metric tube nickel plated

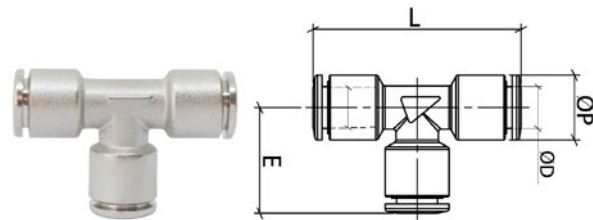

CODE	ØD	ØP	E	L	WEIGHT G
OTRUT04-532	4	10	18	36	17,0
OTRUT0600	6	12	19,5	39	20,0
OTRUT08-516	8	14	22,5	45	30,0
OTRUT1000	10	16	25,5	51	37,0
OTRUT1200	12	19	29	58	68,0

OTRUT-N

Union tee inch tube nickel plated

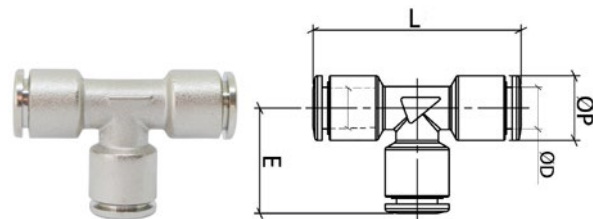

CODE	ØD	ØP	E	L	WEIGHT G
OTRUT04-532	5/32"	0,393	0,708	1,417	16,9
OTRUT1-4	1/4"	0,551	0,826	1,633	26,8
OTRUT08-516	5/16"	0,551	0,885	1,771	29,7
OTRUT38	3/8"	0,649	0,984	1,988	38,3
OTRUT1-2	1/2"	0,767	1,122	2,263	58,7

OTRGJ

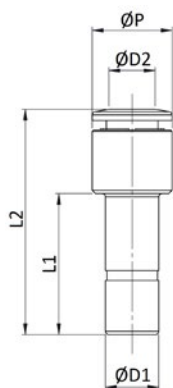

Stem reduction metric tube nickel plated

CODE	ØD1	ØD2	ØP	L1	L2	WEIGHT G
OTRGJ0604	6	4	10	19,50	31	6,0
OTRGJ0806	8	6	12	21,50	34,50	8,0
OTRGJ1008	10	8	14	22,50	36,50	13,0
OTRGJ1210	12	10	16	25,0	40,50	18,0